

ROTATION

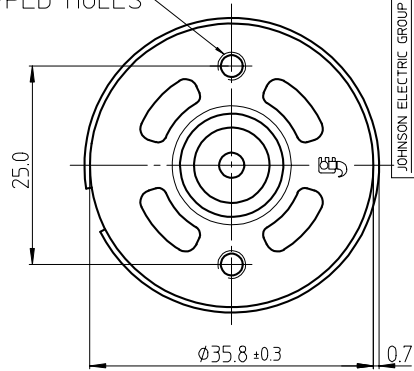

2 ~ M3.0
TAPPED HOLES



DIRECT PRINT PART NO. & DATE CODE ONTO REAR HSG.. CHARACTERS ARE TO BE BLACK OF MIN. HEIGHT 3mm. & NON-REMOVABLE.

DATE CODE FORMAT:-
 FIRST DIGIT - STAND FOR LOCATION CODE
 e.g. 1 FOR P01 & P12, 3 FOR 301, 8 FOR 801
 SECOND DIGIT - STAND FOR PRODUCTION YEAR e.g. 7 FOR 1997
 THIRD & FOURTH DIGITS - STAND FOR PRODUCTION WEEK
 e.g. 50 FOR 50TH WEEK
 FIFTH DIGIT - STAND FOR WEEK DAY
 e.g. 1 FOR MONDAY, 2 FOR TUESDAY, 3 FOR WEDNESDAY,
 4 FOR THURSDAY, 5 FOR FRIDAY, 6 FOR SATURDAY
 0 FOR SUNDAY.
 LAST DIGIT - STAND FOR LOT NUMBER

NOTES:-

1. LENGTH OF SHAFT, DIM. "A" 76.0 mm..
2. FRONT EXTENSION, DIM. "B" 13.5 mm., MEASURED WITH SHAFT PUSHED AGAINST METAL END CAP.
3. DIRECTION OF ROTATION : ANTI-CLOCKWISE WHEN VIEWING MOTOR OUTPUT END WITH POSITIVE VOLTAGE APPLIED TO POSITIVE TERMINAL.
4. END PLAY : 0.50 mm. MAX..
5. MAX. MALE SCREW LENGTH SHOULD NOT EXCEED 3.0mm.

JOHNSON ELECTRIC GROUP OF COMPANIES ('JOHNSON ELECTRIC')
 This document is the Property of Johnson Electric and the information therein is confidential. Unauthorised reproduction or other use thereof, whether directly or indirectly in whole or in part, is prohibited. All rights reserved. This document is the property of Johnson Electric. © Copyright Johnson Electric S.A. 1997. All rights reserved.

ALL DIMENSIONS ARE IN MILLIMETRES

DO NOT SCALE DRAWING

B		COMM. & MAGNET CHANGED, FAN ADDED DIRECT PRINT WAS LABEL			
ALT. REF.	DESCRIPTION			BY	DATE
MATERIAL	FINISH		TOLERANCES 1 DEC. PLACE ± 0.15 2 DEC. PLACES ± 3 DEC. PLACES ± ANGULAR ± 2°		A3
TITLE			SCALE	15:1	DATE
(HC 683 LG) MOTOR OUTLINE			DWN. BY	ERIC	12/12/97
			CHK. BY		
			APP. BY		
JOHNSON ELECTRIC ENGINEERING LTD. a Johnson Electric Group company JOHNSON BUILDING, CHAI WAN, HONG KONG.			DWG. NO.		66530-99900 B