

Polypropylene Film Capacitor

Type: **ECQF**

Non-inductive construction using Polypropylene film with epoxy resin coating and impregnated wax

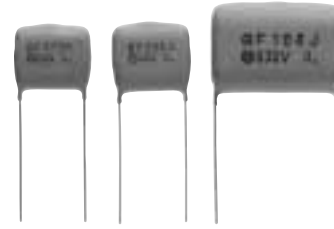

■ Features

- ◆ Low loss and excellent frequency characteristics
- ◆ High insulation and moisture resistance

■ Recommended Applications

- ◆ High frequency and high current circuits
- ◆ General purpose circuits

■ Explanation of Part Numbers

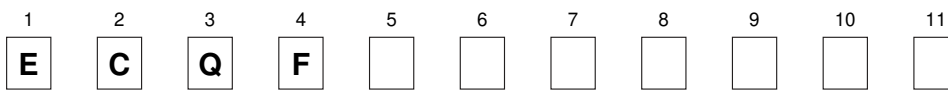

Product code	Dielectric & construction	Rated volt.	Capacitance	Cap. Tol.	Suffix	Suffix
	200VDC 400VDC 630VDC		±5% ±10% ±20%	Straight Crimped lead		
	2 4 6		J K M	Blank H		

● Explanation of Part Number for Odd Size Taping

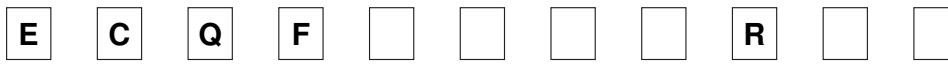

Product code	Dielectric & construction	Rated volt.	Capacitance	7.5mm Crimped lead	Cap. Tol.	Suffix

■ Specifications

Category temp. range	-25 to +85°C (For a higher temperature than 70°C, derating is required.)
Rated voltage	200VDC, 400VDC, 630VDC (Derating is required according to cap. value.)
Capacitance range	0.001 to 0.47μF
Capacitance tolerance	±5%(J), ±10%(K), ±20%(M)
Dissipation factor	0.1%max. (20°C, 1kHz)
Withstand voltage	Between terminals : Rated volt.(VDC)×250% 1 to 5s
Insulation resistance	C≤0.33μF : 45000MΩmin. C>0.33μF : 15000MΩ μFmin. (20°C, 100VDC 60s)

■ Dimensions in mm(not to scale)

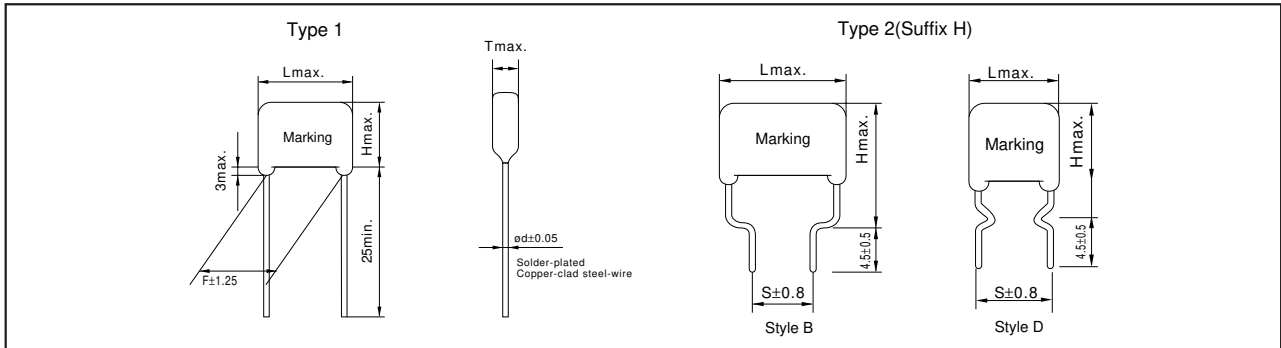

■ Packaging Specifications for Bulk Package

Packing quantity:100pcs./bag

■ Taping Specifications for Automatic Insertion

● Taping style

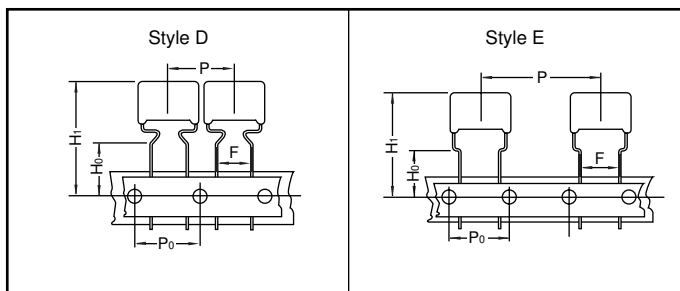

● Packaging Specifications

Type	Rated volt.	Cap. range (μF)	Taping style						Packing
			AD	AS	B	C	D	E	
ECQF	200VDC	0.022 to 0.068						○	Ammo
	400VDC	0.0082 to 0.068						○	Ammo
	600VDC	0.001 to 0.0039						○	Ammo
		0.0047 to 0.022						○	Ammo

● Lead Spacing

Style	Lead Spacing
D	7.5mm
E	7.5mm

* See the column "Rating, Dimensions & Quantity Box" for packing quantity.

■ Rating, Dimensions & Quantity/Ammo Box

● Rated voltage : 200VDC, Capacitance tolerance : ±5%(J), ±10%(K), ±20%(M)

Part No.	Cap. (μF)	Dimensions (mm)							Quantity
		L max.	T max.	H max.		F	S	ød	
				Type-1	Type-2				Type-1
ECQF2223 S ()	0.022	18.5	6.0	12.0	17.0	13.50	10.0	0.60	500
ECQF2273 S ()	0.027	18.5	6.0	12.5	17.5	13.50	10.0	0.60	
ECQF2333 S ()	0.033	18.5	6.0	13.0	18.0	13.50	10.0	0.60	
ECQF2393 S ()	0.039	18.5	6.0	14.5	19.5	13.50	10.0	0.60	
ECQF2473 S ()	0.047	18.5	6.5	15.0	20.0	13.50	10.0	0.60	
ECQF2563 S ()	0.056	18.5	7.0	15.5	20.5	13.50	15.0	0.60	
ECQF2683 S ()	0.068	18.5	7.5	16.0	21.0	13.50	15.0	0.60	300
ECQF2823 S ()	0.082	24.5	7.0	15.5	20.5	19.50	15.0	0.70	
ECQF2104 S ()	0.01	24.5	8.0	15.5	20.5	19.50	15.0	0.70	—
ECQF2124 S ()	0.12	24.5	7.5	16.0	21.0	19.50	15.0	0.70	
ECQF2154 S ()	0.15	25.0	8.5	17.0	23.0	19.50	20.0	0.70	
ECQF2184 S ()	0.18	25.0	9.5	18.0	24.0	19.50	20.0	0.70	
ECQF2224 S ()	0.22	25.5	10.0	18.5	24.5	19.50	20.0	0.70	
ECQF2274 S ()	0.27	25.5	11.0	20.0	26.0	19.50	20.0	0.70	
ECQF2334 S ()	0.33	26.0	12.0	21.0	27.0	19.50	20.0	0.70	
ECQF2394 S ()	0.39	26.0	13.5	22.0	29.0	19.50	20.0	0.80	
ECQF2474 S ()	0.47	26.5	14.5	23.5	31.5	19.50	20.0	0.80	

Suffix for lead crimped or taped type
Cap. tol. code

StyleD: 0.056 to 0.068, 0.15 to 0.47 μF
StyleB: 0.022 to 0.047, 0.082 to 0.12 μF

● Rated voltage : 400VDC, Capacitance tolerance : ±5%(J), ±10%(K), ±20%(M)

Part No.	Cap. (μF)	Dimensions (mm)							Quantity	
		L _{max.}	T _{max.}	H _{max.}		F	S	ød	Ammo	
				Type-1	Type-2					
ECQF4822 Z ()	0.0082	18.5	7.0	13.0	18.0	13.50	10.0	0.60	500	
ECQF4103 Z ()	0.01	18.5	7.0	14.5	19.5	13.50	10.0	0.60		
ECQF4123 Z ()	0.012	18.5	7.0	14.5	19.5	13.50	10.0	0.60		
ECQF4153 Z ()	0.015	18.5	7.0	14.5	19.5	13.50	10.0	0.60		
ECQF4183 Z ()	0.018	18.5	7.0	14.5	19.5	13.50	10.0	0.60		
ECQF4223 Z ()	0.022	18.5	7.5	15.0	20.0	13.50	10.0	0.60		
ECQF4273 Z ()	0.027	18.5	8.0	17.0	22.0	13.50	10.0	0.60	400	
ECQF4333 Z ()	0.033	18.5	8.5	17.5	22.5	13.50	15.0	0.60		
ECQF4393 Z ()	0.039	18.5	9.0	18.0	23.0	13.50	15.0	0.60		
ECQF4473 Z ()	0.047	18.5	10.0	18.5	23.5	13.50	15.0	0.60	300	
ECQF4563 Z ()	0.056	24.5	8.0	17.0	22.0	19.50	15.0	0.70		
ECQF4683 Z ()	0.068	24.5	9.0	18.0	23.0	19.50	15.0	0.70		
ECQF4823 Z ()	0.082	24.5	10.0	18.5	23.5	19.50	15.0	0.70	—	
ECQF4104 Z ()	0.1	25.0	10.5	19.5	26.5	19.50	20.0	0.70		
ECQF4124 Z ()	0.12	25.0	11.5	20.5	27.5	19.50	20.0	0.70		
ECQF4154 Z ()	0.15	25.5	12.5	21.5	28.5	19.50	20.0	0.70		
ECQF4184 Z ()	0.18	32.0	12.5	21.5	27.5	25.50	20.0	0.80		
ECQF4224 Z ()	0.22	32.0	13.0	21.5	27.5	25.50	20.0	0.80		
ECQF4274 Z ()	0.27	32.0	15.5	24.5	30.5	25.50	20.0	0.80		
ECQF4334 Z ()	0.33	32.0	16.0	25.0	31.0	25.50	20.0	0.80		
ECQF4394 Z ()	0.39	39.0	16.5	25.0	31.0	31.00	20.0	0.80		
ECQF4474 Z ()	0.47	39.0	17.0	25.5	31.5	31.00	20.0	0.80		

StyleD: 0.033 to 0.047, 0.1 to 0.15 μF
StyleB: 0.0082 to 0.027, 0.056 to 0.082, 0.18 to 0.47 μF

● Rated voltage : 630VDC, Capacitance tolerance : ±5%(J), ±10%(K), ±20%(M)

Part No.	Cap. (μF)	Dimensions (mm)							Quantity	
		L _{max.}	T _{max.}	H _{max.}		F	S	ød	Ammo	
				Type-1	Type-2					
ECQF6102 Z ()	0.001	12.5	6.0	12.0	17.0	8.50	10.0	0.60	1000	
ECQF6122 Z ()	0.0012	12.5	6.0	12.0	17.0	8.50	10.0	0.60		
ECQF6152 Z ()	0.0015	12.5	6.0	12.0	17.0	8.50	10.0	0.60		
ECQF6182 Z ()	0.0018	12.5	6.0	12.0	17.0	8.50	10.0	0.60		
ECQF6222 Z ()	0.0022	12.5	6.0	13.5	18.5	8.50	10.0	0.60		
ECQF6272 Z ()	0.0027	12.5	6.5	14.0	19.0	8.50	10.0	0.60		
ECQF6332 Z ()	0.0033	12.5	7.0	14.5	19.5	8.50	10.0	0.60	500	
ECQF6392 Z ()	0.0039	12.5	7.5	15.0	20.0	8.50	10.0	0.60		
ECQF6472 Z ()	0.0047	18.5	7.0	12.5	17.5	13.50	10.0	0.60		
ECQF6562 Z ()	0.0056	18.5	7.5	13.0	18.0	13.50	10.0	0.60		
ECQF6682 Z ()	0.0068	18.5	7.0	12.5	17.5	13.50	10.0	0.60		
ECQF6822 Z ()	0.0082	18.5	7.0	14.5	19.5	13.50	10.0	0.60		
ECQF6103 Z ()	0.01	18.5	7.5	15.0	20.0	13.50	10.0	0.60	400	
ECQF6123 Z ()	0.012	18.5	7.5	16.5	21.5	13.50	10.0	0.60		
ECQF6153 Z ()	0.015	18.5	8.0	17.0	22.0	13.50	15.0	0.60		
ECQF6183 Z ()	0.018	18.5	8.5	18.0	23.0	13.50	15.0	0.60	300	
ECQF6223 Z ()	0.022	18.5	9.5	18.5	23.5	13.50	15.0	0.60		
ECQF6273 Z ()	0.027	24.5	8.0	17.0	22.0	19.50	15.0	0.70	—	
ECQF6333 Z ()	0.033	24.5	9.0	17.5	22.5	19.50	15.0	0.70		
ECQF6393 Z ()	0.039	24.5	10.0	18.5	23.5	19.50	15.0	0.70		
ECQF6473 Z ()	0.047	25.0	10.5	19.5	24.5	19.50	15.0	0.70		
ECQF6563 Z ()	0.056	25.0	11.5	20.0	27.0	19.50	20.0	0.70		
ECQF6683 Z ()	0.068	25.5	12.5	21.0	28.0	19.50	20.0	0.70		
ECQF6823 Z ()	0.082	32.0	12.0	20.5	26.5	25.50	20.0	0.80		
ECQF6104 Z ()	0.1	32.0	12.5	21.0	27.0	25.50	20.0	0.80		
ECQF6124 Z ()	0.12	32.0	14.5	23.5	29.5	25.50	20.0	0.80		
ECQF6154 Z ()	0.15	32.0	15.0	24.0	30.0	25.50	20.0	0.80		
ECQF6184 Z ()	0.18	39.0	16.0	24.5	30.5	31.00	20.0	0.80		
ECQF6224 Z ()	0.22	39.0	16.0	24.5	30.5	31.00	20.0	0.80		

— Suffix for lead crimped or taped type
— Cap. tol. code

StyleD: 0.001 to 0.0039, 0.015 to 0.022, 0.056 to 0.068 μF
StyleB: 0.0047 to 0.012, 0.027 to 0.047, 0.082 to 0.22 μF