

ROTATION

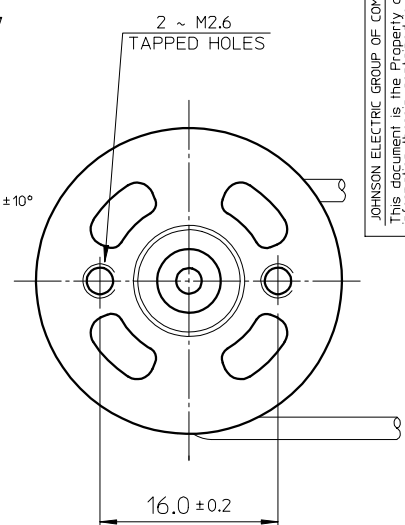
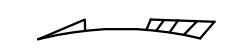

SOLDERING (SEE NOTE 6)
LEAD OF CAPACITOR AND LEADWIRE END SHOULD BE PUT THROUGH THE TERMINAL HOLE AS SHOWN BEFORE SOLDERING

DIRECT PRINT CUSTOMER CODE & DATE CODE ONTO REAR HOUSING CHARACTERS TO BE BLACK & NON-REMOVABLE OF MINIMUM HEIGHT 2.0 mm. DATE CODE FORMAT:-
FIRST DIGIT - STAND FOR LOCATION CODE e.g. 1 FOR P01 & P12, 3 FOR 301, 8 FOR 801
SECOND DIGIT - STAND FOR PRODUCTION YEAR e.g. 9 FOR 1999
THIRD & FOURTH DIGITS - STAND FOR PRODUCTION WEEK. e.g. 02 FOR 2nd WEEK
FIFTH DIGIT - STAND FOR WEEK DAY e.g. 0 FOR SUNDAY, 1 FOR MONDAY, 2 FOR TUESDAY, 3 FOR WEDNESDAY, 4 FOR THURSDAY, 5 FOR FRIDAY, 6 FOR SATURDAY.
LAST DIGIT - STAND FOR LOT NUMBER

NOTES:

1. LENGTH OF SHAFT. DIM. "A" 60.0 mm.
2. FRONT EXTENSION. DIM. "B" 16.75 mm. MEASURED WITH SHAFT PUSHED AGAINST PLASTIC END CAP.
3. DIRECTION OF ROTATION: ANTI-CLOCKWISE WHEN VIEWING MOTOR OUTPUT END WITH POSITIVE VOLTAGE APPLIED TO POSITIVE TERMINAL.
4. END PLAY: 0.15-0.50 mm.
5. PART (36180-10900) MUST BE PLACED CLOSELY TO BUSHING HSG. WHEN SHAFT IN EXTREME RIGHT POSITION. IT WOULD NOT SCRAPE ON BUSHING HSG. SURFACE.
6. REMAINING LENGTH OF CAPACITOR LEAD NOT BE EXCEED 2 MM.
7. THE CAPACITOR MUST BE POSITIONED AS CLOSE AS TO THE CENTER LINE OF 2 CRIMPING SLOT.

A		FIRST ISSUE			
ALT. REF.	DESCRIPTION			BY	DATE
MATERIAL	FINISH	TOLERANCES		A3	
		1 DEC. PLACE ± 0.15 2 DEC. PLACES ± 3 DEC. PLACES ± ANGULAR ± 2°			
TITLE			SCALE	2 : 1	DATE
(HC 355 MG)			DWN. BY	W.F.L.	01/09/98
MOTOR OUTLINE			CHK. BY		
			APP. BY		
JOHNSON ELECTRIC IND. MFTY. LTD.			DWG. NO.		
a Johnson Electric Group company					
JOHNSON BUILDING, TAI PO, HONGKONG.			36140-99900		

THIS DOCUMENT IS THE PROPERTY OF JOHNSON ELECTRIC (JOHNSON ELECTRIC) AND THE INFORMATION CONTAINED HEREIN IS CONFIDENTIAL. UNAUTHORIZED REPRODUCTION OR OTHER USE OF THIS DOCUMENT IS STRICTLY PROHIBITED. ALL RIGHTS RESERVED. © COPYRIGHT JOHNSON ELECTRIC S.A. 1998.