

Kontakteinsatz
contact unit

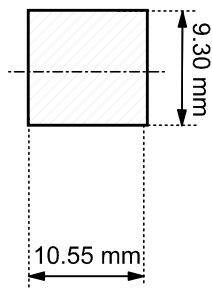

Isolierhülle
insulation cover

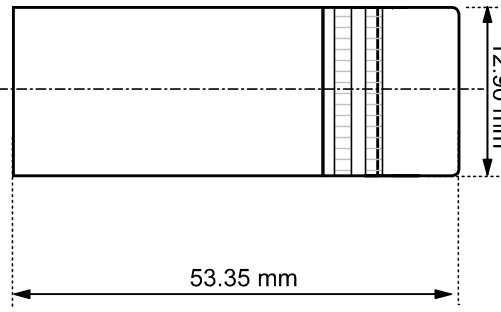

Gehäusehülle
body

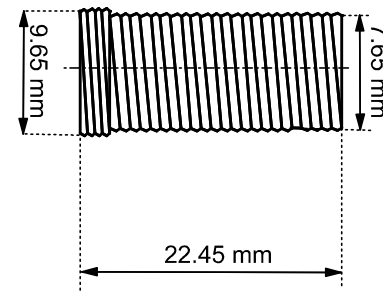

Kickschutzfeder
bend protection



- Klinkenkupplung - 6,35 mm - stereo
- Metallausführung mit Knickschutz
- RoHS-konform

- jack - 6.35 mm - stereo
- metal version with cable protector
- RoHS-compliant

Änderungen

| Datum | Name | gez.: | Datum | Name |
|-------|------|-------|------------|------|
| | | li | 01.12.2008 | li |
| | | li | 01.12.2008 | li |
| | | | Norm: | |

| | | | |
|-----------------|-------|-------|--|
| Bezeichnung | | Blatt | |
| KS 63 MK | 11071 | | |
| Zeichnungs-Nr.: | | | |

| |
|-----|
| von |
|-----|