

**SPECIFICATION:**

Operating Current (Nom.):	1 A
Operating Temperature:	-25°C to 85°C
Insulation Resistance (Min.):	1000 MΩ
Contact Resistance (Max.):	15 mΩ
Dielectric Strength:	500 Vac

**MATERIAL:**

Material (Housing):	steel, tin plated
Flammability Class:	UL 94 V-0
Material (Insulation):	PBT
Material (Contact Area):	brass, gold plated

**HANDLING:**

Terminal:	IDC
Packaging:	tray

**TOLERANCE:**

.X:	± 0.38
.XX:	± 0.25

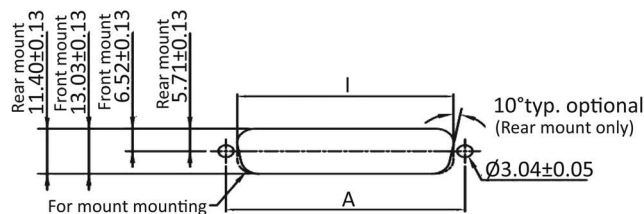
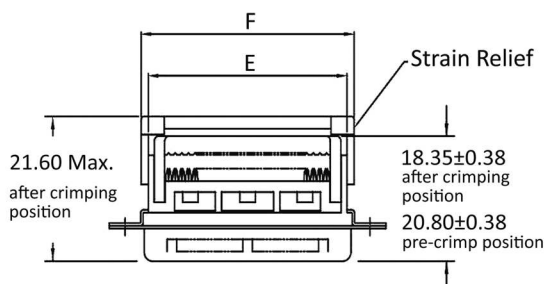

Recommended panel cutout dimensions

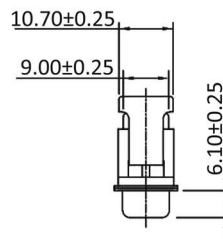
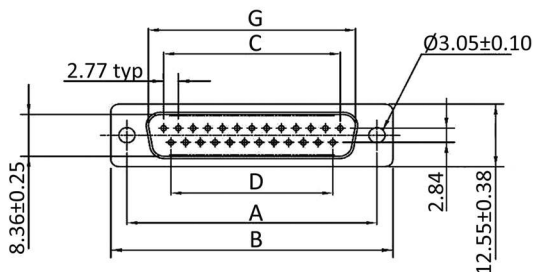

**Dimensions**

Number of Contacts:	A:	B:	C:	D:	E:	F:	G:	I Front:	I Rear:
9	24.99	30.8	11.08	8.31	16.1	18.6	16.92	22.2	20.47
15	33.32	39.10	19.39	16.62	24.00	26.5	25.25	30.53	28.80
25	47.04	53.09	33.24	30.47	38.14	40.9	38.96	44.27	42.52
37	63.5	69.4	49.86	47.09	54.6	57.1	55.45	60.73	59.08

**Order Information**

Identifier:	No. of Contacts:	Contact Plating:	Shell:	/	Mounting:	Insulator Colour:
ST	#	#	K	/	F	
D-Sub Male IDC	9: 9 poles 15: 15 poles 25: 25 poles 37: 37 poles	S: selective gold plated * G: gold plated A: 5 μ" gold	metal shell with plastic strain relief	/	mounting hole	black

\* = Standard