

		Conditions
<b>cell type:</b>	NiMH	
<b>cell size:</b>	AA	
<b>nominal voltage:</b>	1.2 V	
<b>max. charge voltage:</b>	1.5 V	at standard charge (0.1C / 20°C)
<b>capacity</b>		
nominal:	1300 mAh	discharge at 0.2C
minimum:	1300 mAh	discharge at 0.2C
	1200 mAh	discharge at 1C
		1.0V end discharge voltage
		ta: 20°C
<b>max. continuous discharge current:</b>	3900 mA	ta: 0...45°C
<b>charge</b>	current	time
standard charge:	130 mA	14....16hrs
quick charge:	390 mA	4hrs
fast charge:	1300 mA	1.1hrs
recommended charge termination control parameters:	0...5 mV 0.8...1 °C 45...50 °C	- ΔV (-deltaV) temperature rise per minute TCO (temperature cut off)
trickle charge current:	10...30 mA	(recommended)
continuous overcharge: (less than 1 year)	≤ 130 mA	no conspicuous deformation no leakage
<b>internal resistance:</b> (impedance)	≤ 45 mΩ	at 1KHz battery fully charged
<b>life expectancy:</b>	≥ 500 cycles	acc. IEC standard
<b>self discharge</b>		
charge retention:	≥ 80 %	after 12 months storage at 20°C
<b>initial capacity:</b>	≥ 900 mAh	within 30 days after delivery discharge at 0.2C
<b>ambient temperature range:</b>	0...45 °C 10...40 °C - 20...65 °C - 20...50 °C - 20...40 °C - 20...30 °C	standard charge fast charge discharge storage (≤3months) storage (≤6months) storage (≤24months)

### Diagrams

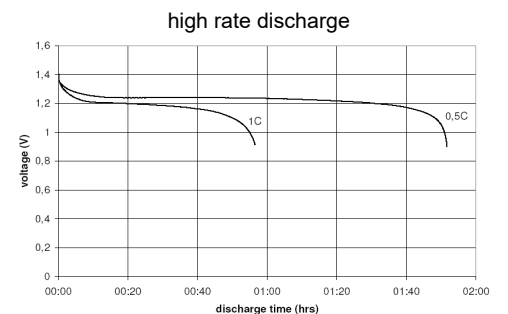
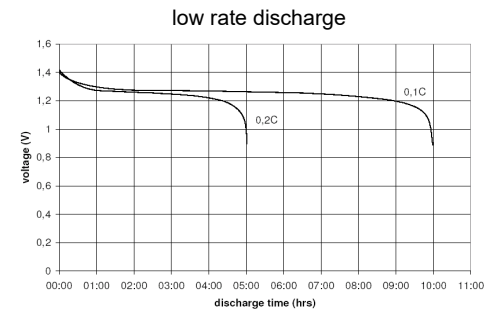
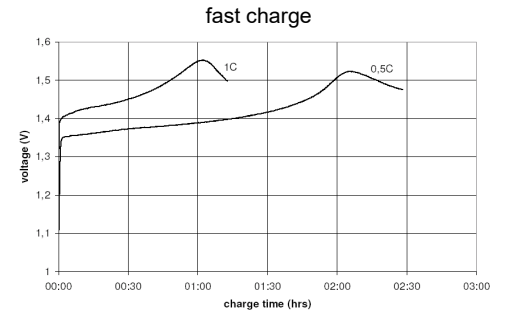
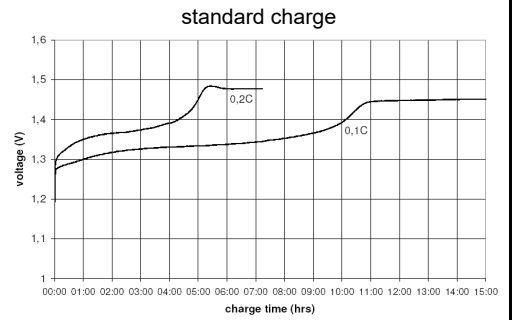

QCT1: 20/1250/45  
QCT2: 30/1150/50

### mechanical specifications

cell dimensions

diameter d1:		14.3 - 0.7	mm
diameter d2:	max.	5.5	mm
height h1:		50.4 - 0.5	mm
height h2:	min.	1.2	mm
weight:		23 ± 2	g

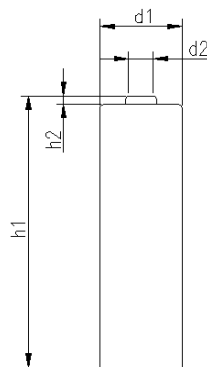

	<b>ANSMANN Specifications for model:</b>	<b>NiMH Battery</b>
		<b>AA - 1300mAh low self discharge</b>
	data sheet no. / part no.	
	supplier no.	702069
author / date	TG / 10.08.2018	